

**PRICE
DROP**

**BRAND NEW
SKYLINE HOME
Now \$167,000**

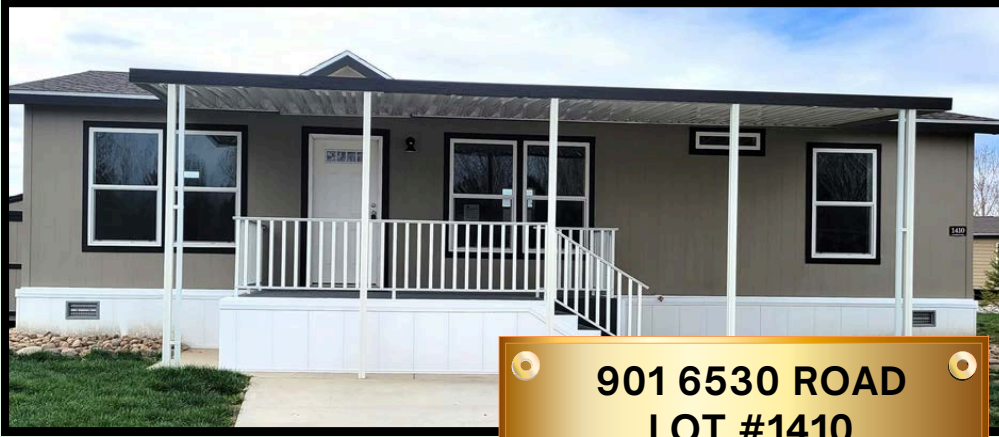

**901 6530 ROAD
LOT #1410
MONTROSE, CO**



PROPERTY FEATURES



3 Bedroom



2 Bathroom



**Electric Tile
Fireplace**

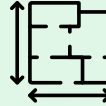

1162 SF



8x8 Matching Shed

\$167,000

5% Down/25 Year Term

***ONLY \$1,985.00**

per month*

**(\$1,309.00 mortgage plus
\$676.00 lot rent)**

CONTACT US

970-249-0493

manager@cimarroncreekcommunity.com

www.cimarroncreekcommunity.com

WAC. Estimated payment, rates and terms may vary based on credit history. Not all applicants will qualify. Subject to lender terms & conditions. Actual term, rate, APR, and loan amount may vary.



CIMARRON CREEK
Welcome Home



CIMARRON CREEK

**901 6530 ROAD
LOT #1410
MONTROSE, CO**

BRAND NEW SKYLINE HOME

- 3 BED/2 BATH
- 1162 SQUARE FEET
- OPEN CONCEPT SPLIT FLOOR PLAN
- KITCHEN ISLAND WITH LARGE WORK TOP
- STAINLESS STEEL APPLIANCES
- ELECTRIC TILE FIREPLACE
- KITCHEN ISLAND WITH LARGE WORK TOP
- 8X8 MATCHING SHED

